



3699 Kinsman Blvd.  
Madison, WI 53704 U.S.A.  
www.bellabs.com

EPA EST. NOs. 12455-WI-1k,  
12455-WI-2<sup>p</sup>, 12455-WI-3<sup>w</sup>  
Superscript is first letter of the lot number.



3699 Kinsman Blvd.  
Madison, WI 53704 U.S.A.  
www.bellabs.com

EPA EST. NOs. 12455-WI-1k,  
12455-WI-2<sup>p</sup>, 12455-WI-3<sup>w</sup>  
Superscript is first letter of the lot number.



3699 Kinsman Blvd.  
Madison, WI 53704 U.S.A.  
www.bellabs.com

EPA EST. NOs. 12455-WI-1k,  
12455-WI-2<sup>p</sup>, 12455-WI-3<sup>w</sup>  
Superscript is first letter of the lot number.

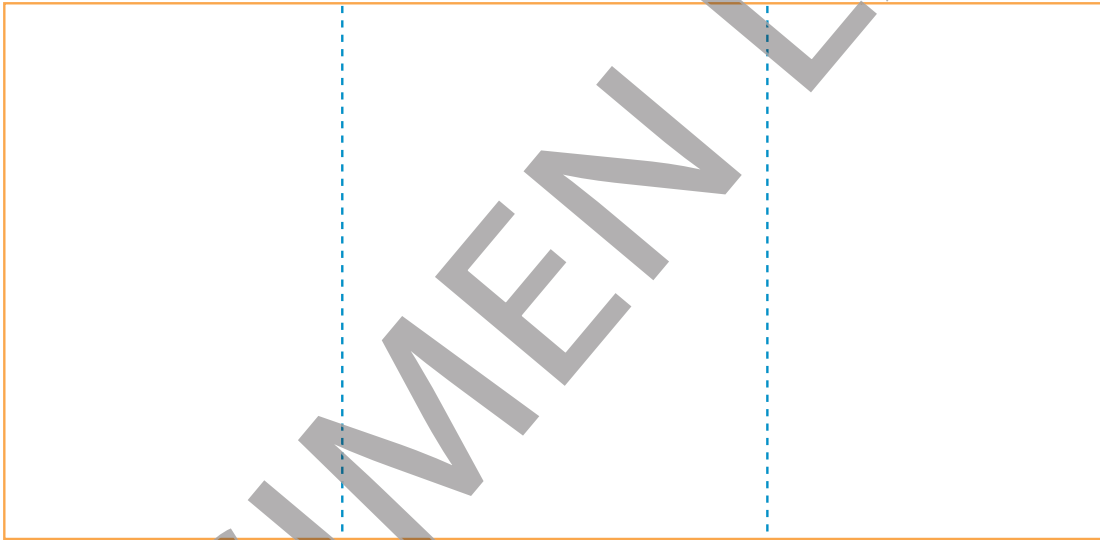

DO NOT REMOVE

\_\_\_\_\_  
DATE  
\_\_\_\_\_  
LOCATION

9311-4

DO NOT REMOVE

\_\_\_\_\_  
DATE  
\_\_\_\_\_  
LOCATION

DO NOT REMOVE

\_\_\_\_\_  
DATE  
\_\_\_\_\_  
LOCATION

110617

3915P  
2001-2

## TRAPPER® ROACH ATTRACTANT

### NONPOISONOUS DIRECTIONS FOR USE

Use TRAPPER Roach Attractant to attract roaches to TRAPPER Monitor Insect Traps. Place one or two pieces in the center of each TRAPPER Monitor glue pad.

**Net Weight: 0.7oz (20 g)**

Manufactured by:

 **Bell**  
LABORATORIES, INC.  
www.belllabs.com  
Madison, WI 53704 U.S.A.  
EPA EST. NOs. 12455-WI-1K, 12455-WI-2P, 12455-WI-3W  
Superscript is first letter of the lot number.

122717

## To use the Monitor & Insect Trap

1. Fold the trap on the 2 lengthwise scores on either side of the adhesive pad.

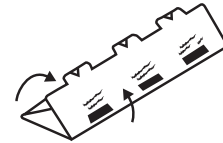

2. To separate into 2 or 3 smaller traps fold the closed trap at the perforations which separate the 3 sections. After folding, tear the sections apart.

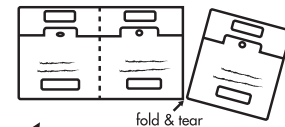

3. Remove paper from adhesive pad.

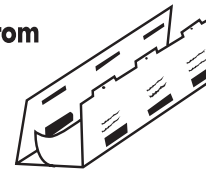

4. Insert tabs into slots to make enclosed trap.



5. If trap is to be attached to a surface, remove narrow paper strip on the bottom of the trap and press trap to surface in desired position.

6710